

OPC: Offset Plaster Channel Screed

- Special Sizes Available, Contact Customer Service For Details
 - Available With 1/8", 1/4" Vent Holes or No Holes
 - Available Curved Upon Request
 - Available in Aluminum (A), Copper (C), Galvanized Steel (GS), Bonderized (BN), Galvalume® (GVM), Stainless Steel (SS) or Zinc (Z)
- (See Our Materials Guide For Details, Page 40)

A channel screed style reveal molding with return keys for screeding. Provides a longer leg on one side for dissimilar depths of materials, such as EIFS. Available with 1/8" weep holes.

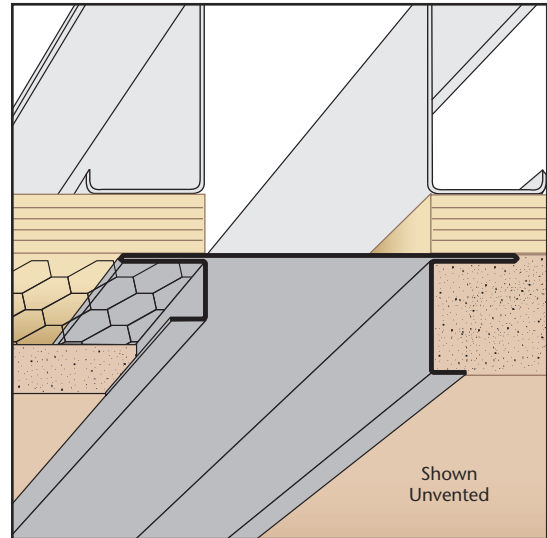

Most Common Sizes

- X Sizes:** 3/8", 1/2", 5/8", 3/4", 7/8" or 1"
- Y Sizes:** 3/4", 1", 1 1/2", 2", 2 1/2" or 3"
- Z Sizes:** 1/2", 3/4", 7/8", 1", 1 1/4", 1 1/2", 1 3/4" or 2"
- Length:** 120"

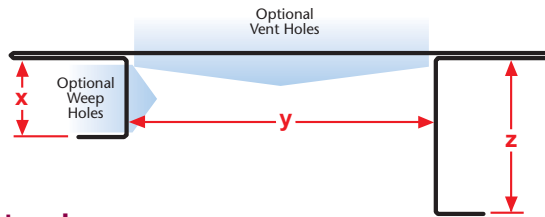

Most Common Part Numbers:

- OPC012 100 034A** OPC: X=1/2, Y=1, Z=3/4, A, 10'
- OPC038 100 078** OPC: X=3/8, Y=1, Z=7/8, GS, 10'
- OPC058 012 078A** OPC: X=5/8, Y=1/2, Z=7/8, A, 10'
- OPC078 034 134A** OPC: X=7/8, Y=3/4, Z=1 3/4, A, 10'

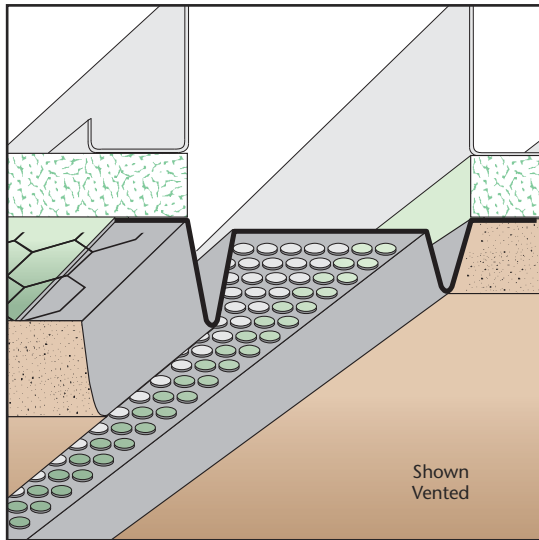

OVS: Offset Vent/Reveal Screed

- Special Sizes Available, Contact Customer Service For Details
 - Available With 1/8", 1/4" Vent Holes or No Holes
 - Available Curved Upon Request
 - Available in Aluminum (A), Copper (C), Galvanized Steel (GS), Bonderized (BN), Galvalume® (GVM), Stainless Steel (SS) or Zinc (Z)
- (See Our Materials Guide For Details, Page 40)

A variation of our standard vent screed which provides a larger depth on one side to accommodate materials of dissimilar depths.

Most Common Sizes

- X Sizes:** 1/2", 3/4" or 7/8"
- Y Sizes:** 3/4", 1", 1 1/2", 2", 2 1/2", 3", 3 1/2", 4", 4 1/2", 5", 5 1/2" or 6"
- Z Sizes:** 3/8", 1/2", 3/4", 7/8", 1" or 1 3/8"
- Length:** 120"

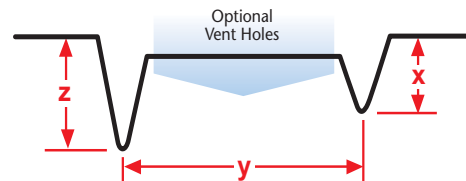

Most Common Part Numbers:

- OVS012 034 038** OVS: X=1/2, Y=3/4, Z=3/8, GS, 10'