

EXTRUDED

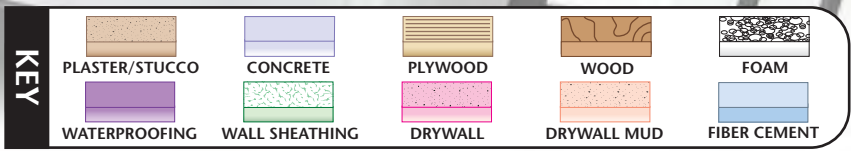

DS: Drip Screed

- Available With 1/8" x 1" Vent Slots or No Vents
- Available in Aluminum Alloy (6063 T-5)

An aesthetically pleasing drip screed for conventional 3-coat stucco that functions as a plaster stop/drip edge and creates a reveal at the fascia/soffit corner condition.

Note: *1 3/8" X Size available in 7/8" Y Size only.

Note: **2" not available vented.

Note: Not all X Sizes (Depth) or Y Sizes (Reveal) combinations are available. Please consult with customer service.

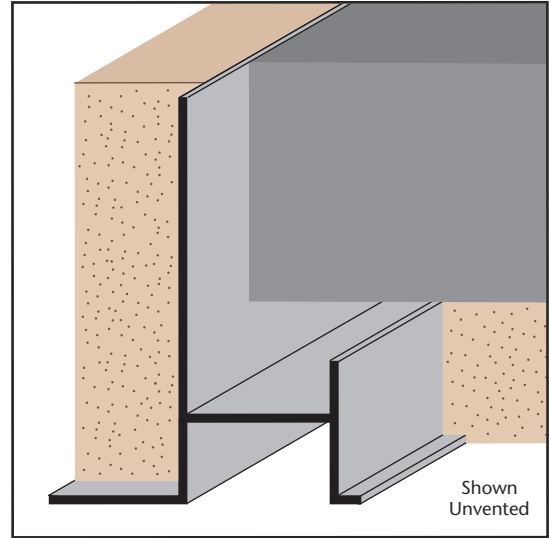

Shown Unvented

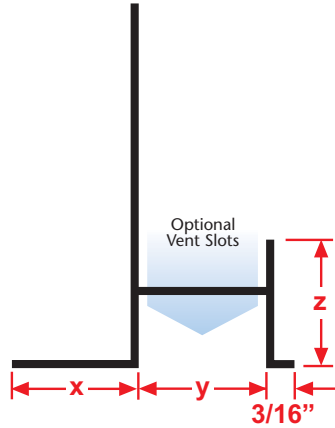

Most Common Sizes

X Sizes: 7/8" or *1 3/8"

Y Sizes: 3/4", 7/8", **2" or 3"

Z Sizes: 7/8"

Length: 10'

Most Common Part Numbers:

DS375 875EC DS: X=3/16, Y=7/8, Z=7/8, Clear Anod, AL, 10'

DS875EC DS: X=7/8, Y=7/8, Z=7/8, Clear Anod, AL, 10'

DS875EC DS: X=7/8, Y=7/8, Z=7/8, Clear Anod, AL, 10'

DS875ECR DS: X=7/8, Y=7/8, Z=7/8, Chem-Film, AL, 10'

DS875ES DS: X=7/8, Y=7/8, Z=7/8, Stripped Finish, AL, 10'

DS875EMB DS: X=7/8, Y=7/8, Z=7/8, Medium Bronze Anod, AL, 10'

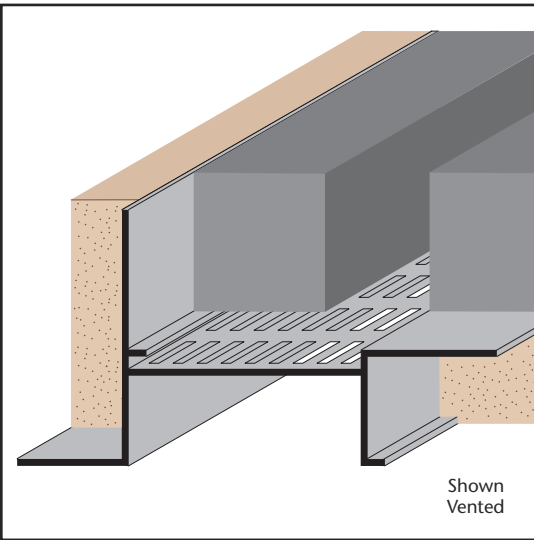

Shown Vented

DS300: Drip Screed 3" Reveal

- Available With 1/8" x 1" Vent Slots or No Vents
- Available Curved Upon Request
- Available in Aluminum Alloy (6063 T-5)

An aesthetically pleasing drip screed for conventional 3-coat stucco that functions as a plaster stop/drip edge and creates a reveal at the fascia/soffit corner condition.

Note: Available vented. Non-vented is a special order. Please consult with customer service.

Most Common Sizes

X Sizes: 7/8"

Y Sizes: 3"

Length: 10'

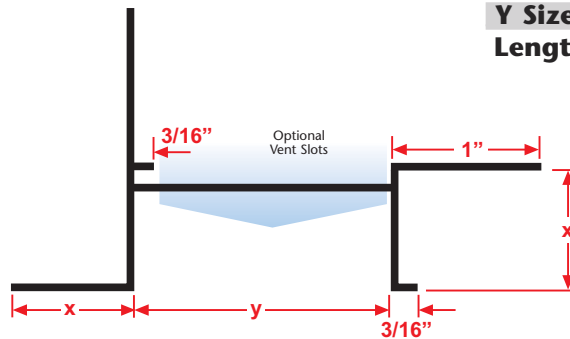

Most Common Part Numbers:

DS300 875 300EC DS300: X=7/8, Y=3, Clear Anod, AL, 10'

DS300 875 300ES DS300: X=7/8, Y=3, Stripped Finish, AL, 10'