



SPECIAL SIZES AVAILABLE!

Contact Stockton Custom Fabrication at (877) 786-2587

EXTRUDED

PCS DA: Plaster Channel Screed DA

- Available With 1/8" x 1" Vent Slots or No Vents
- Available With 1/8" Weep Holes Slots or No Weep Holes
- Available Curved Upon Request
- Available in Aluminum Alloy (6063 T-5)

A decorative reveal used as a plaster stop/control screed for direct applied and one coat systems.

Most Common Sizes

X Sizes: 3/8"

Y Sizes: 1/2", 3/4", 1", 1 1/2"

Length: 10'

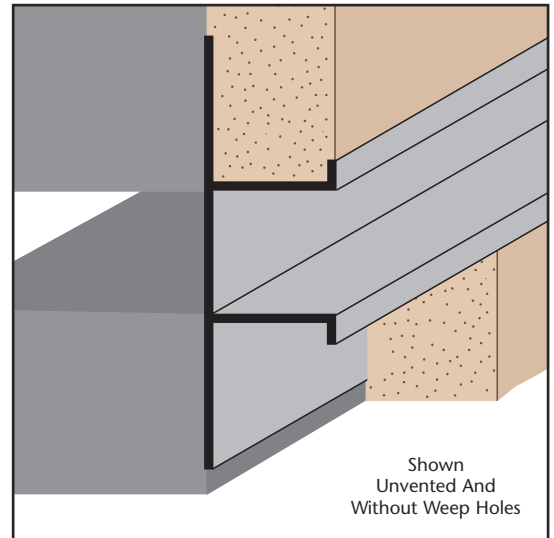
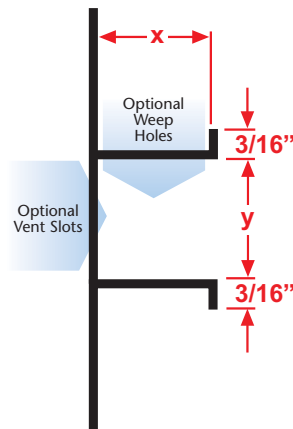

Most Common Part Numbers:

PCSDA375 50EC PCS DA: X=3/8, Y=1/2, Clear Anodize, AL, 10'

PCSDA375 75EK PCS DA: X=3/8, Y=3/4, Fluorophore Paint, AL, 10'

PCSDA375 75SE PCS DA: X=3/8, Y=3/4, Mill Finish, AL, 10'

PCSDA375 150EPC PCS DA: X=3/8, Y=1 1/2, Powder Coat, AL, 10'

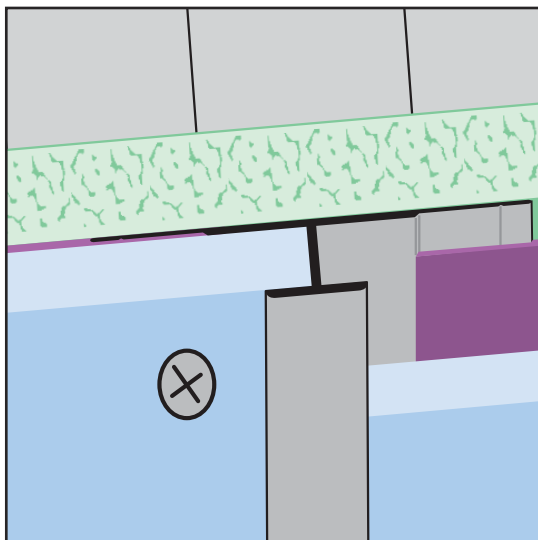

PJ-FCP: Panel Joiner for Fiber Cement Panel

- Available in Aluminum Alloy (6063 T-5)

A functional trim piece used to join two panels together in a vertical condition.

Note: Do not use in a horizontal condition.

Most Common Sizes

X Sizes: 3/8"

Length: 10'

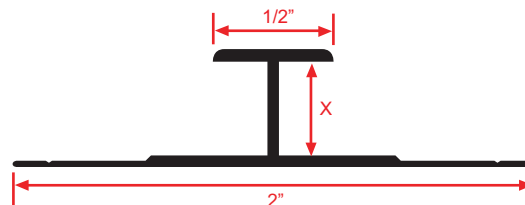

Most Common Part Numbers:

PJ FCP375 50EC PJ-FCP: X=3/8, Y=1/2, Clear Anodize, AL, 10'

PJ FCP375 50ECH PJ-FCP: X=3/8, Y=1/2, Chem-Film, AL, 10'

PJ FCP375 50EP PJ-FCP: X=3/8, Y=1/2, Powder Coated, AL, 10'