

F-D 75-75: F Drip Molding

- Available With 1/8" Weep Holes or No Vents
- Available Curved Upon Request
- Available in Aluminum Alloy (6063 T-5)

Provides a plaster stop/drip molding with an aesthetic reveal for window heads, tops of door frames and plate conditions where a drip edge is required.

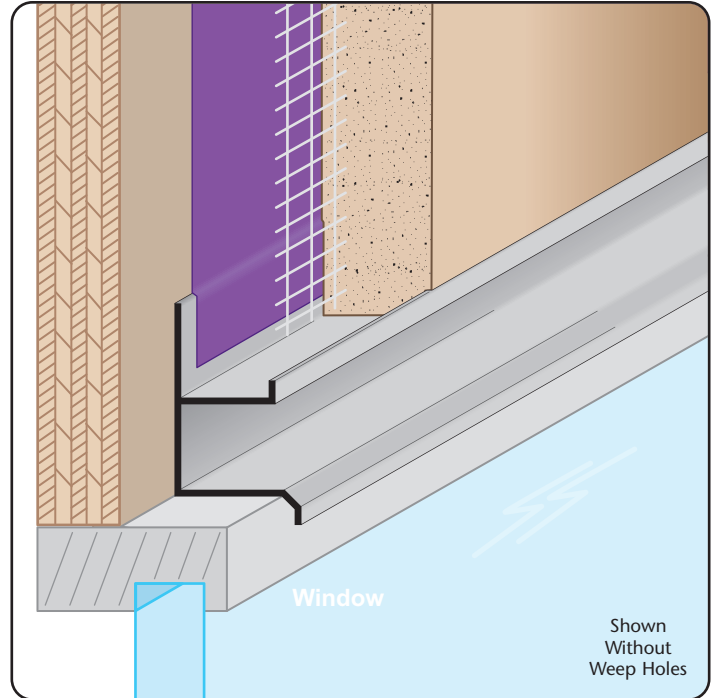

Shown Without Weep Holes

Most Common Sizes
X Sizes: 3/4" or 1 3/8"
Length: 10'

Materials And Finishes:

Details: stpro.us/EXT

Aluminum Alloy (6063 T-5)

ASTM Codes:

Details: stpro.us/ASTM

AA-M32-C10A21, AAMA 605.2, C841, C1047, C1063, B136-84, B244-97, D4214-98, ND1730-67-TYPE B

Most Common Part Numbers:

- F D75 75EC** F-D 75 75: X=3/4, Y=3/4, Clear Anodize, A, 10'
- F D75 75EDB** F-D 75 75: X=3/4, Y=3/4, Dark Bronze, A, 10'
- F D75 75ES** F-D 75 75: X=3/4, Y=3/4, Stripped Finish, A, 10'
- F D75W75ECH** F-D 75 75: X=3/4, Weep, Y=3/4, Chem-Film, A, 10'

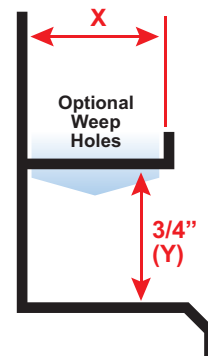

QUOTE	Company: _____	QTY: _____	PO Number: _____
	Name: _____	Material: Aluminum Alloy (6063 T-5)	Job/Project: _____
	Address: _____	X Size: _____	Notes: _____
	City: _____	Length: _____	_____
	State/ZIP: _____	Weep Holes: <input type="checkbox"/> None <input type="checkbox"/> 1/8"	_____
	Phone: _____		_____
	eMail: _____		_____

877-786-2587 • StocktonProducts.com

