



CUSTOM SIZES AVAILABLE!

Stockton Custom Fabrication

877-786-2587

custom@StocktonProducts.com



PRODUCTS™

OWS: Offset Weep Screed

- Custom Sizes Available, Contact Customer Service For Details
- SUPERIOR® Moisture Protection
- Available With 1/2" Weep Holes or No Weep Holes
- Available Curved Upon Request
- Available in Aluminum (A), Copper (C), Galvanized Steel (GS), Bonderized (BN), Galvalume® (GVM), Stainless Steel (SS) or Zinc (Z)

A special weep screed for those conditions where the shear wall exceeds the foundation in plane. This special design permits the bottom leg of the weep screed to return back to the foundation. Available with dual weep holes to allow full passthrough of moisture.

Most Common Sizes

X Sizes: 1/2", 3/4", 7/8", 1", 1 3/8" or 1 1/2"

Y Sizes: 3 1/2", 4", 4 1/2" or 5"

Z Sizes: 1", 1 1/4", 1 3/8", 1 1/2" or 2"

Length: 120"

Materials And Finishes:

Details: stpro.us/MET

Aluminum (A), Copper (C), Galvanized Steel (GS), Bonderized (BN), Galvalume® (GVM), Stainless Steel (SS) or Zinc (Z)

ASTM Codes:

Details: stpro.us/ASTM

All Accessories are fabricated from prime galvanized steel G90 zinc coating by the hot dipped method, conforming to steel and coating specification ASTM A-653/A-653M or zinc alloy meeting ASTM B-69. Stainless Steel A480/A480M A580M (Stainless Steel) For installation and placement instructions refer to ASTM C1063, C841 and C926.

Most Common Part Numbers:

OWS078W312 138L OWS: X=7/8, 1/2 Weep Hole, Y=3 1/2, Z=1 3/8, GS, 10'

OWS138W312 158L OWS: X=1 3/8, 1/2 Weep Hole, Y=3 1/2, Z=1 5/8, GS, 10'

OWS138W312 200L OWS: X=1 3/8, 1/2 Weep Hole, Y=3 1/2, Z=2, GS, 10'

OWS138W334 200L OWS: X=1 3/8, 1/2 Weep Hole, Y=3 3/4, Z=2, GS, 10'

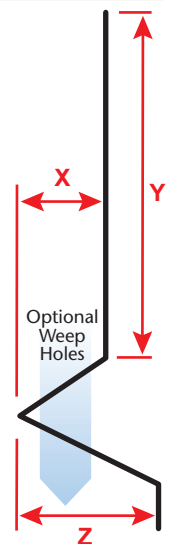
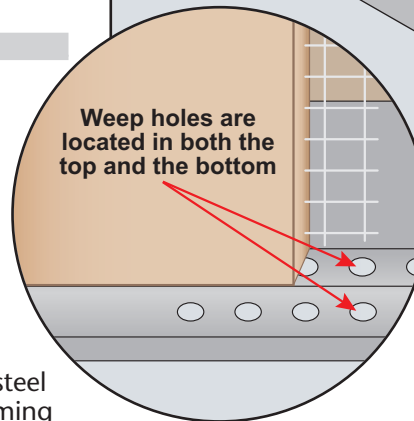
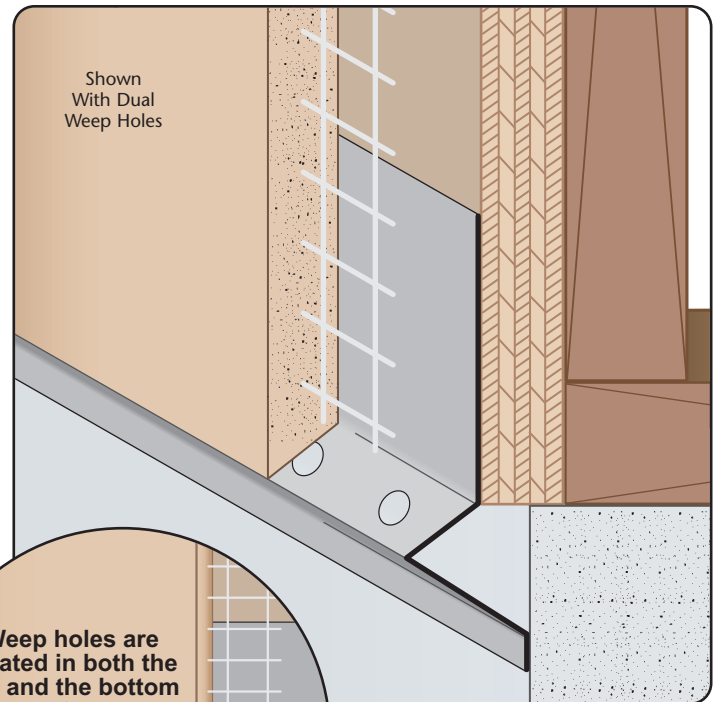

QUOTE	Company: _____	QTY: _____	PO Number: _____
	Name: _____	Material/Gauge: _____	Job/Project: _____
	Address: _____	X Size: _____	Notes: _____
	City: _____	Y Size: _____	_____
	State/ZIP: _____	Z Size: _____	_____
	Phone: _____	Weep Holes: <input type="checkbox"/> None <input type="checkbox"/> 1/2"	_____
	eMail: _____		_____

877-786-2587 • StocktonProducts.com

