



**CUSTOM SIZES AVAILABLE!**

Stockton Custom Fabrication

877-786-2587

custom@StocktonProducts.com



**PRODUCTS™**

# PSV: Plywood Style Vent

- Custom Sizes Available, Contact Customer Service For Details
- Available With 1/8", 1/4" Vent Holes or No Holes
- Available Pre-Painted Brown (B), White (W) or Unpainted (G)
- Galvanized Steel (GS) Only

Specialty soffit vent for use with plywood soffit conditions.

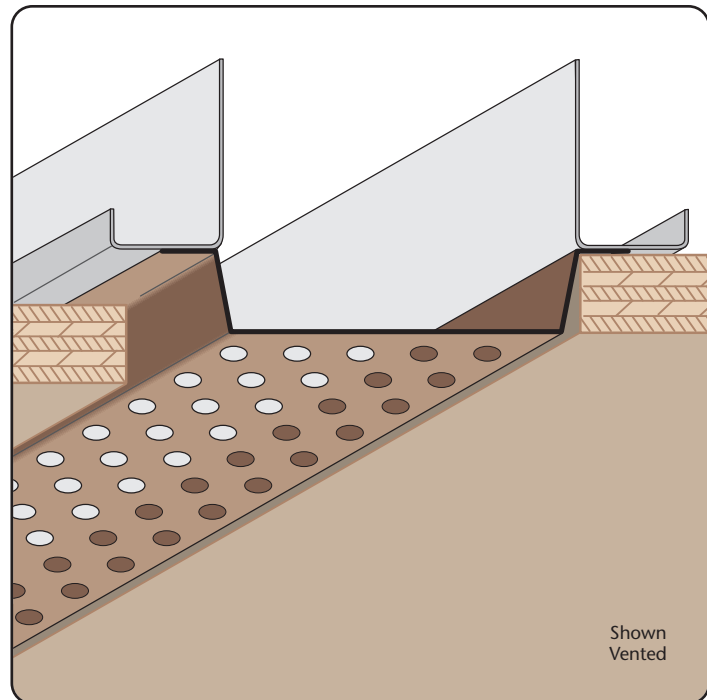

Shown Vented

### Most Common Sizes

**X Sizes:** 1/2", 3/8"

**Y Sizes:** 3/4", 2 1/4" or 4"

**Length:** 120"

### Materials And Finishes:

Details: [stpro.us/MET](http://stpro.us/MET)

Galvanized Steel (GS)

### ASTM Codes:

Details: [stpro.us/ASTM](http://stpro.us/ASTM)

653-CS, A1018, A262, A36, A513, A653, A792, A924, B 370-12, B-209, B-209, B6/B69, C1047, C1063, C841, ML/SFA 920

### Most Common Part Numbers:

**PSV012 034** PSV: X=1/2, 1/8 Vent, Y=3/4, GS, 10'

**PSV012V214B** PSV: X=1/2, 1/8 Vent, Y=2 1/4, GS, 10', Brown

**PSV012V214BJ** PSV: X=1/2, 1/4 Vent, Y=2 1/4, GS, 10', Brown

**PSV012V214GJ** PSV: X=1/2, 1/4 Vent, Y=2 1/4, GS, 10', UnPainted

**PSV012V214W** PSV: X=1/2, 1/8 Vent, Y=2 1/4, GS, 10', White

**PSV012V214WJ** PSV: X=1/2, 1/4 Vent, Y=2 1/4, GS, 10', White

**PSV012V400** PSV: X=1/2, 1/8 Vent, Y=4, GS, 10'

**PSV038V400JB** PSV: X=3/8, 1/4 Vent, Y=4, GS, 10', Brown

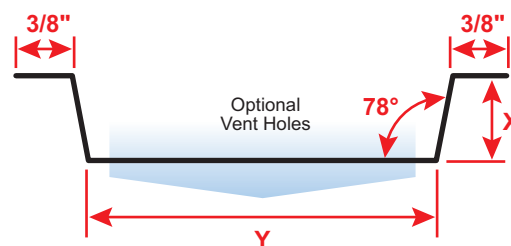

<b>QUOTE</b>	Company: _____	QTY: _____	PO Number: _____
	Name: _____	Material/Gauge: _____	Job/Project: _____
	Address: _____	X Size: _____	Notes: _____
	City: _____	Y Size: _____	_____
	State/ZIP: _____	Length: _____	_____
	Phone: _____	Vent Holes: <input type="checkbox"/> None <input type="checkbox"/> 1/8" <input type="checkbox"/> 1/4"	_____
	eMail: _____	Paint: <input type="checkbox"/> None <input type="checkbox"/> Brown <input type="checkbox"/> White	_____

**877-786-2587 • StocktonProducts.com**

