



CUSTOM SIZES AVAILABLE!

Stockton Custom Fabrication

877-786-2587

custom@StocktonProducts.com



PRODUCTS™

SES: Ember Stop® Soffit Vent

- Custom Sizes Available, Contact Customer Service For Details
- Galvanized Steel Only

Allows air in while also designed for protection against ember entry. All the same features and value of our standard SVR screed, but with the addition of a 0.062, 16-16 (1/16") aluminum screen. Includes 1/8" vent holes. US Patent 77,957,955

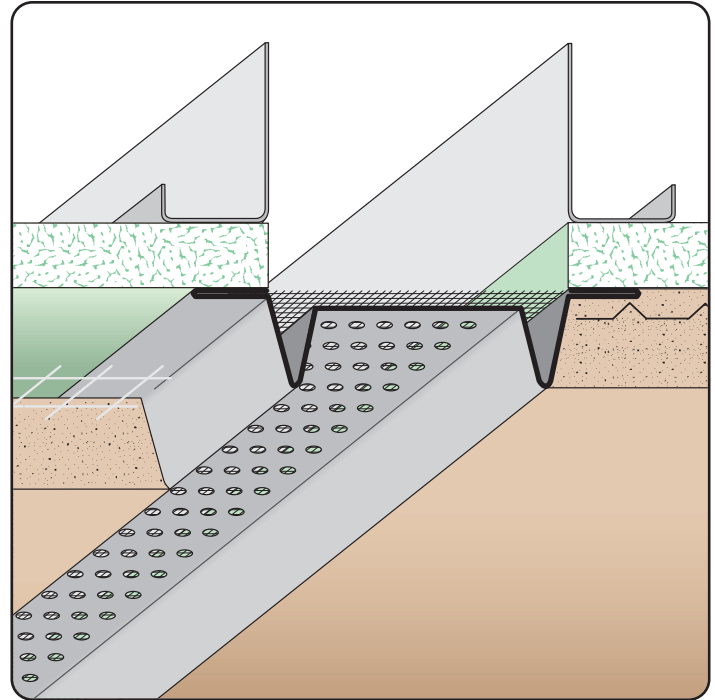

Most Common Sizes

X Sizes: 1/2", 3/4" or 7/8"

Y Sizes: 2", 3" or 4"

Length: 120"

Materials And Finishes:

Details: stpro.us/MET

Galvanized Steel (GS)

ASTM Codes:

Details: stpro.us/ASTM

653-CS, A1018, A262, A36, A513, A653, A792, A924, B
370-12, B-209, B-209, B6/B69, C1047, C1063, C841,
ML/SFA 920

Most Common Part Numbers:

SES012V200 SES: X=1/2, 1/8 Vent, Y=2, GS, 10'

SES012V400 SES: X=1/2, 1/8 Vent, Y=4, GS, 10'

SES034V200 SES: X=3/4, 1/8 Vent, Y=2, GS, 10'

SES034V300 SES: X=3/4, 1/8 Vent, Y=3, GS, 10'

SES034V400 SES: X=3/4, 1/8 Vent, Y=4, GS, 10'

SES078V200 SES: X=7/8, 1/8 Vent, Y=2, GS, 10'

SES078V400 SES: X=7/8, 1/8 Vent, Y=4, GS, 10'

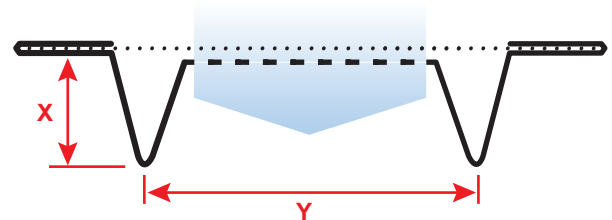

QUOTE	Company: _____	QTY: _____	PO Number: _____
	Name: _____	Material/Gauge: _____	Job/Project: _____
	Address: _____	X Size: _____	Notes: _____
	City: _____	Y Size: _____	_____
	State/ZIP: _____	Length: _____	_____
	Phone: _____		_____
	eMail: _____		_____

877-786-2587 • StocktonProducts.com

