



CUSTOM SIZES AVAILABLE!

Stockton Custom Fabrication

877-786-2587

custom@StocktonProducts.com



SSF: #3 Stucco Screed Flashing

- Custom Sizes Available, Contact Customer Service For Details
- *Water Tested per ASTM E1105*
- SUPERIOR® Moisture Protection
- Available With 1/4" Weep Holes or No Holes
- Available Curved Upon Request
- Available in Aluminum (A), Copper (C), Galvanized Steel (GS), Bonderized (BN), Galvalume® (GVM), Stainless Steel (SS) or Zinc (Z)

SSF combines a stucco screed and head flashing into one uniformed piece. Weep screed allows moisture to escape and travel over top of flashing. SSF provides ideal water management at window head, floor line and transition to dissimilar materials. Available with and without weep holes. US Patent 7,673,421

Most Common Sizes

X Sizes: 1/2", 3/4", 7/8", 1" or 1 1/4"

Y Sizes: 3/4", 1 1/4", 1 1/2" or 2"

Z Sizes: 3/4", 1", 1 1/4", 1 1/2", 1 3/4", 2", 2 1/2" or 3"

Length: 120"

Materials And Finishes:

Details: stpro.us/MET

Aluminum (A), Copper (C), Galvanized Steel (GS), Bonderized (BN), Galvalume® (GVM), Stainless Steel (SS) or Zinc (Z)

ASTM Codes:

Details: stpro.us/ASTM

All Accessories are fabricated from prime galvanized steel G90 zinc coating by the hot dipped method, conforming to steel and coating specification ASTM A-653/A-653M or zinc alloy meeting ASTM B-69. Stainless Steel A480/A480M A580M (Stainless Steel) For installation and placement instructions refer to ASTM C1063, C841 and C926.

Most Common Part Numbers:

SSF012 034 034 SSF: X=1/2, Y=3/4, Z=3/4, GS, 10'

SSF034 012 100 SSF: X=3/4, Y=1/2, Z=1, GS, 10'

SSF034 034 100 SSF: X=3/4, Y=3/4, Z=1, GS, 10'

SSF078 012 100 SSF: X=7/8, Y=1/2, Z=1, GS, 10'

SSF078 012 112 SSF: X=7/8, Y=1/2, Z=1 1/2, GS, 10'

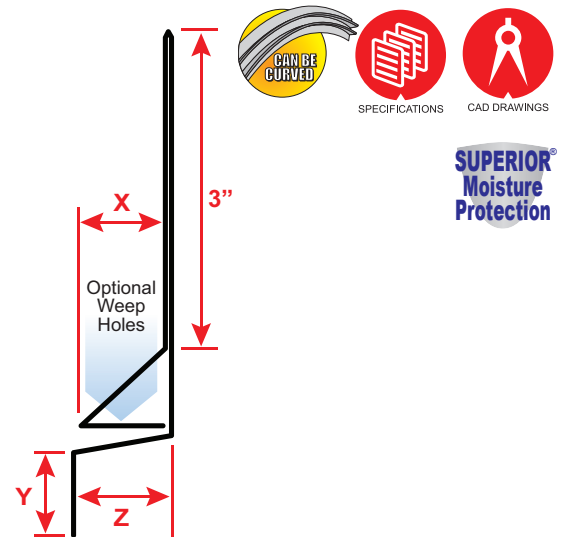
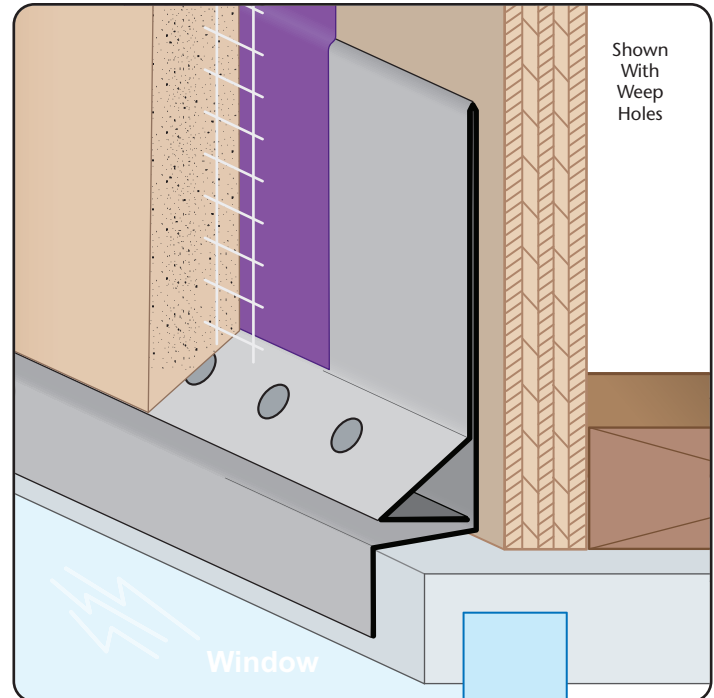

QUOTE	Company: _____	QTY: _____	PO Number: _____
	Name: _____	Material/Gauge: _____	Job/Project: _____
	Address: _____	X Size: _____	Notes: _____
	City: _____	Y Size: _____	_____
	State/ZIP: _____	Z Size: _____	_____
	Phone: _____	Length: _____	_____
	eMail: _____	Weep Holes: <input type="checkbox"/> None <input type="checkbox"/> 1/4"	_____

877-786-2587 • StocktonProducts.com

