



**CUSTOM SIZES AVAILABLE!**

Stockton Custom Fabrication

877-786-2587

custom@StocktonProducts.com



**PRODUCTS™**

# VHS: Vented Hat Screed

- Custom Sizes Available, Contact Customer Service For Details
- Available With 1/8", 1/4" Vent Holes or No Vent
- Available Curved Upon Request
- Available in Aluminum (A), Copper (C), Galvanized Steel (GS), Bonderized (BN), Galvalume® (GVM), Stainless Steel (SS) or Zinc (Z)

This screed offers ventilation while providing a finished, "flush" reveal look. A decorative "flush" reveal for use in a soffit condition.

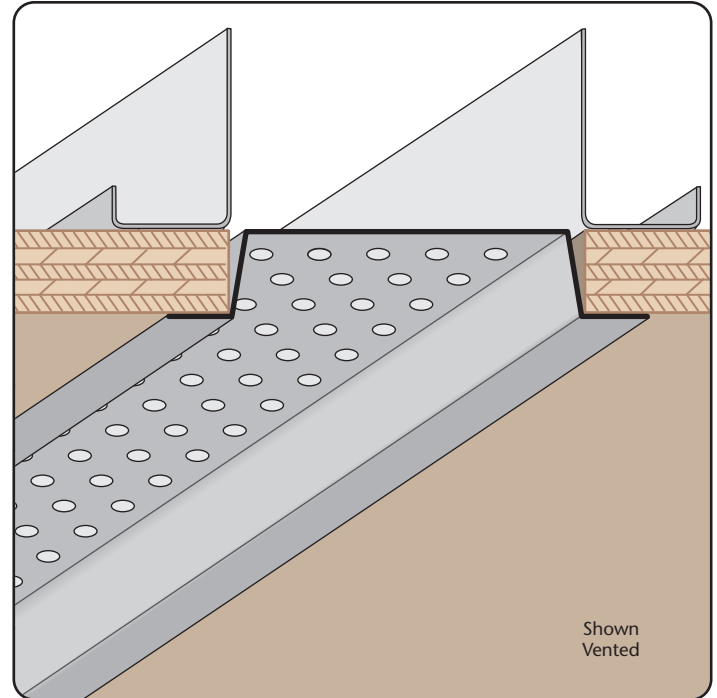

Shown Vented

### Most Common Sizes

**X Sizes:** 3/8", 1/2", 5/8", 3/4", 7/8", 1" or 1 3/8"

**Y Sizes:** 3/4", 1", 1 1/2", 2", 2 1/2", 3", 3 1/2", 4" or 4 1/2"

**Length:** 120"

### Materials And Finishes:

Details: [stpro.us/MET](http://stpro.us/MET)

Aluminum (A), Copper (C), Galvanized Steel (GS), Bonderized (BN), Galvalume® (GVM), Stainless Steel (SS) or Zinc (Z)

### ASTM Codes:

Details: [stpro.us/ASTM](http://stpro.us/ASTM)

653-CS, A1018, A262, A36, A513, A653, A792, A924, B370-12, B-209, B-209, B6/B69, C1047, C1063, C841, ML/SFA 920

### Most Common Part Numbers:

**VHS012V200** VHS: X=1/2, 1/8 Vent, Y=2, GS, 10'

**VHS012V300J** VHS: X=1/2, 1/4 Vent, Y=3, GS, 10'

**VHS034V200** VHS: X=3/4, 1/8 Vent, Y=2, GS, 10'

**VHS034V300J** VHS: X=3/4, 1/4 Vent, Y=3, GS, 10'

**VHS038V200JA** VHS: X=3/8, 1/4 Vent, Y=2, A, 10'

**VHS058V200** VHS: X=5/8, 1/8 Vent, Y=2, GS, 10'

**VHS078V200J** VHS: X=7/8, 1/4 Vent, Y=2, GS, 10'

**VHS516V200L** VHS: X=5/16, 1/2 Vent, Y=2, GS, 10'

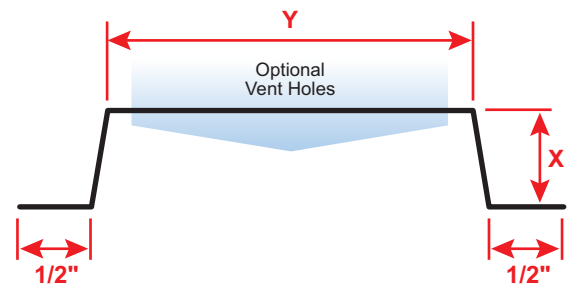

**QUOTE**

Company: \_\_\_\_\_  
 Name: \_\_\_\_\_  
 Address: \_\_\_\_\_  
 City: \_\_\_\_\_  
 State/ZIP: \_\_\_\_\_  
 Phone: \_\_\_\_\_  
 eMail: \_\_\_\_\_

QTY: \_\_\_\_\_  
 Material/Gauge: \_\_\_\_\_  
 X Size: \_\_\_\_\_  
 Y Size: \_\_\_\_\_  
 Length: \_\_\_\_\_  
 Vent Holes:  None  1/8"  1/4"

PO Number: \_\_\_\_\_  
 Job/Project: \_\_\_\_\_  
 Notes: \_\_\_\_\_  
 \_\_\_\_\_  
 \_\_\_\_\_

**877-786-2587 • StocktonProducts.com**

