

# TRUFLUSH™

## Installation Tips



Here are some installation tip for professionally installing the Stockton Products® TruFlush™ TFBO & TFBH.

### Suggested Tools

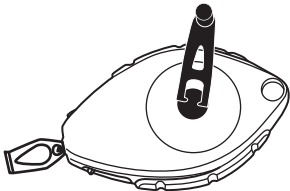

Chalk  
Reel

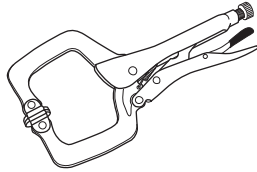

Locking C-Clamp  
with Swivel Pad Tips

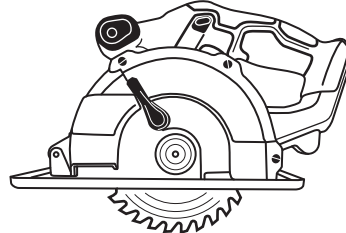

Metal Cutting  
Circular Saw

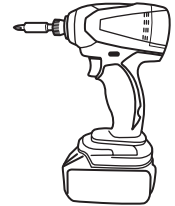

Cordless  
Screwdriver

**1**

Snap a level chalk line down your path for installation with your Chalk Reel.

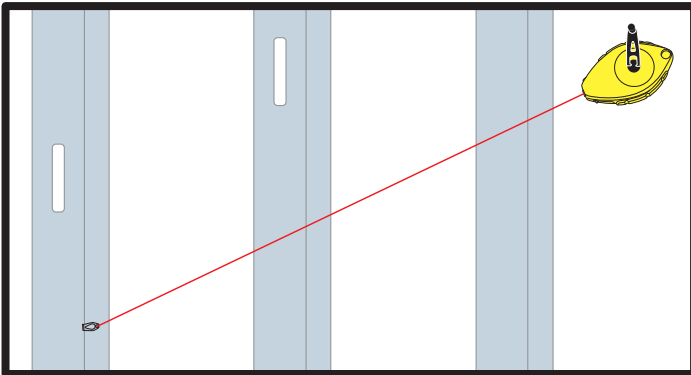

**2**

These 5" length makeup clips have to be locked with C-Clamps into the stud cavity first. The makeup clip should be aligned with the top of the chalk line.

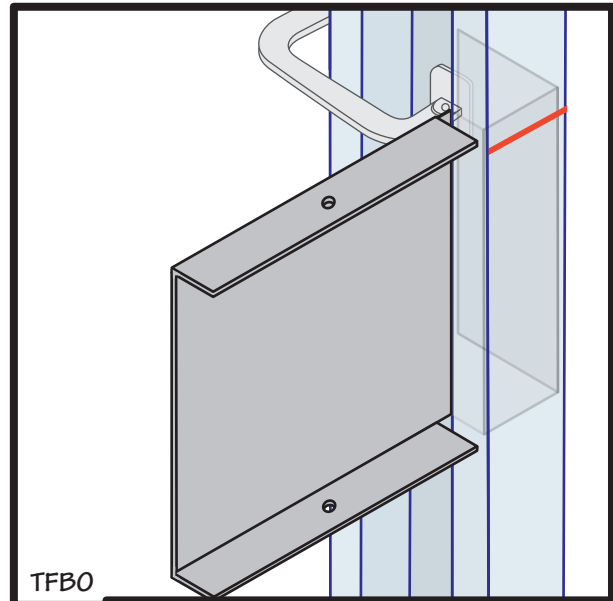

**3**

Measure the space between the studs, then use the Metal Cutting Circular Saw to cut the lengths of the fixed backing (TFB) being sure you choose the end which matches your needs (open to hard, open to open or hard to hard)

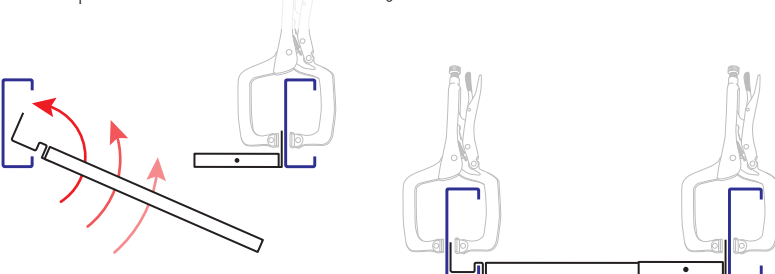
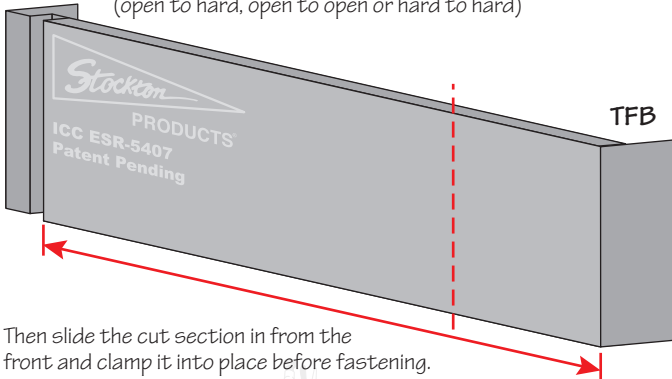

# TRUFLUSH™

## Installation Tips



- 4** Once clamped and aligned to the chalk line, the makeup clip is fastened to the stud first with open channel facing forward

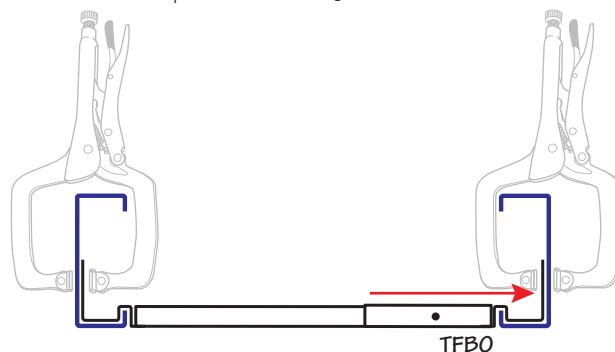
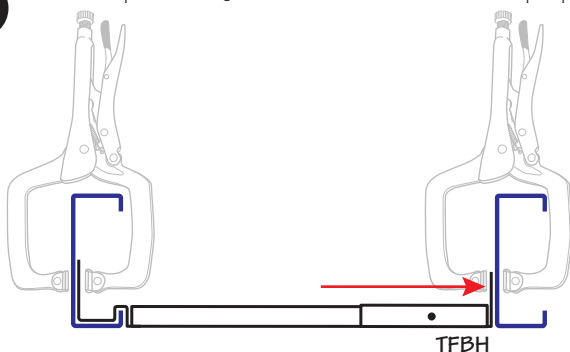

- 5** Followed by the two or three #10 hex head fasteners through the pilot holes on the adjacent stud backing through the stud attaching through the flange on the adjacent backing component

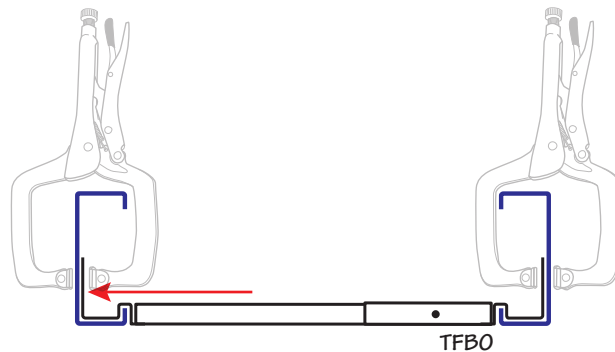
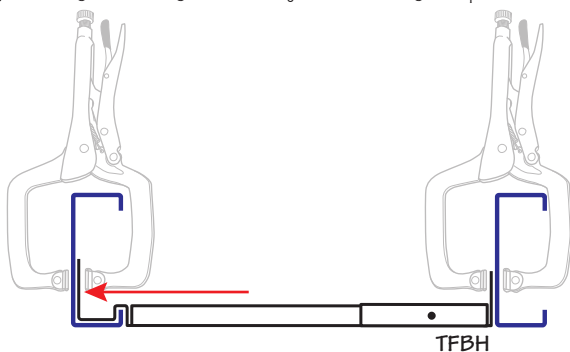

- 6** Once both ends of the backing are fastened, attach two #10 hex head fasteners through the top and bottom of the makeup clip

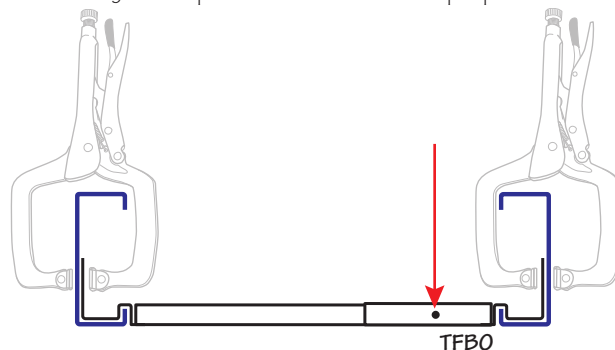
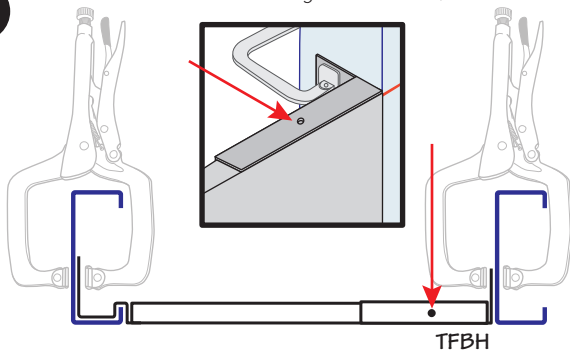

- 7** If needed, two fasteners can then be attached through the side of the U shaped bend pilot holes catching the return lip on the edge of the stud flange

